

PHASE III STRATEGIC PLAN
Rochester School Modernization Program

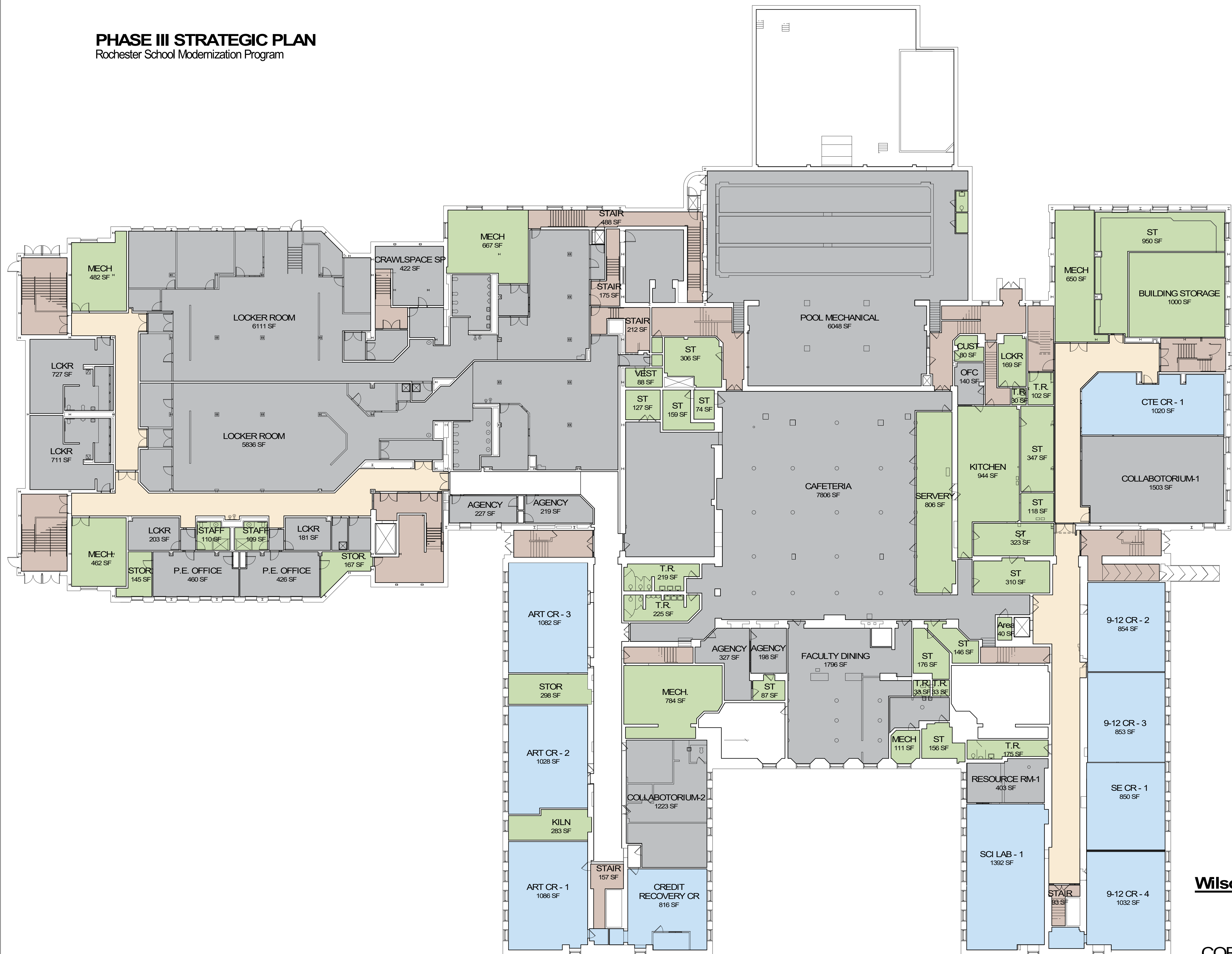

KEY:
ELA (English Language Art)
CTE (Career and Technical Education)
FACS (Family and Consumer Science)
NYSAA (New York State Alternative Assessment)
CSE (Committee on Special Education)
OT/PT (Occupational & Physical Therapy)
LOTE (Language Other Than English)
ATS (Alternative To Suspension)
STEM (Science/Technology/Engineering/Math)
AIS (Academic Intervention Services)
REC (Student Records)
ST (Storage)
GS (General Science)
SS (Social Studies)
CAD (Computer Aided Design)
GR (Grade)
CR (Classroom)

- CIRCULATION
- CIRCULATION ADDITION
- CLASSROOM
- STAIR
- SUPPORT
- TOILET/STORAGE

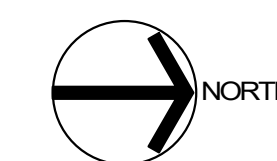

Wilson Commencement High School

501 Genesee St, Rochester, NY 14611

BASEMENT PLAN

CORE MODEL PROGRAM 9-12=880 STUDENTS

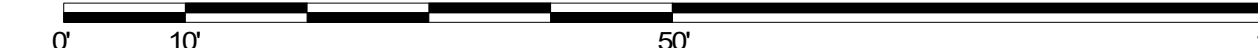

PHASE III STRATEGIC PLAN
Rochester School Modernization Program

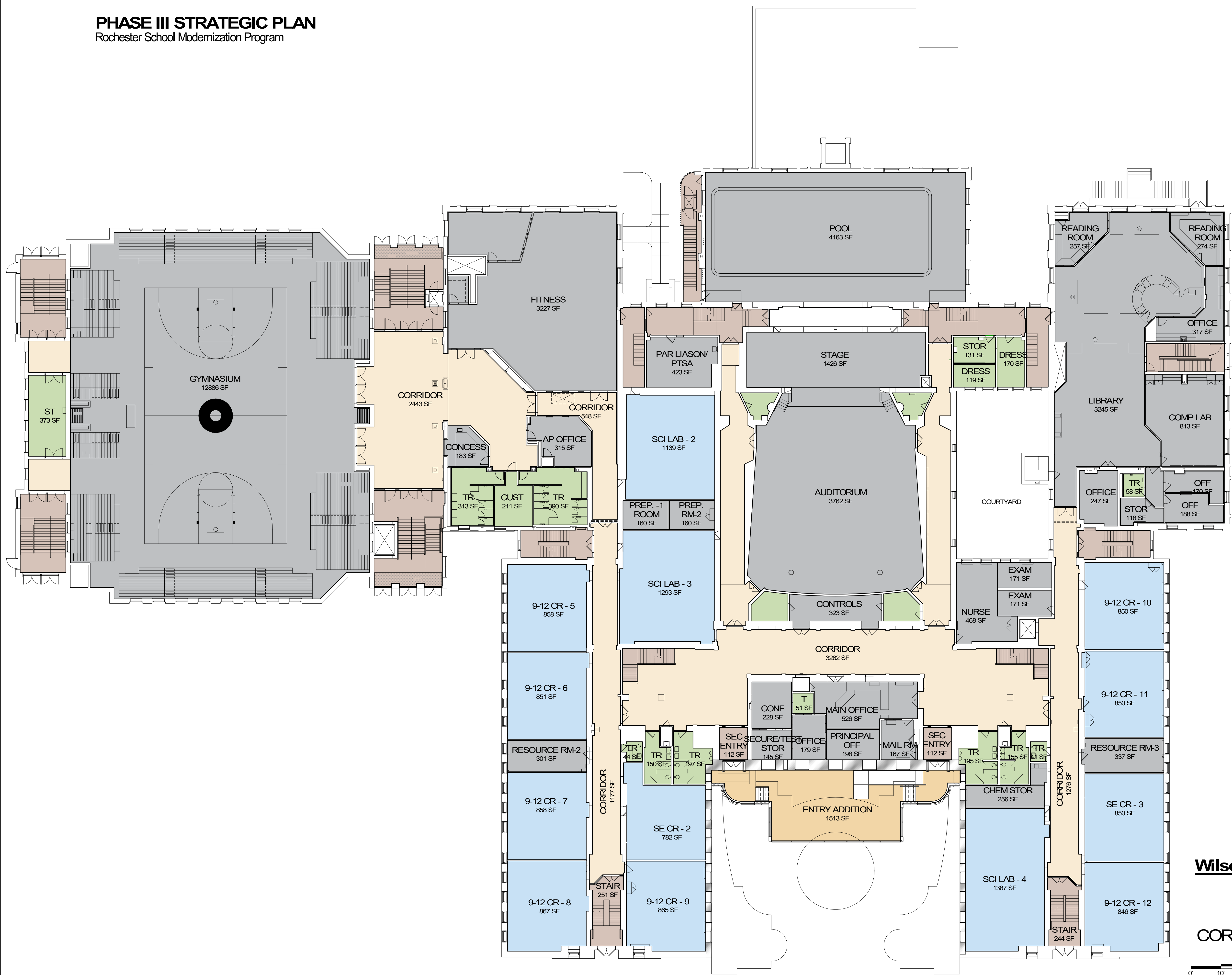

KEY:
ELA (English Language Art)
CTE (Career and Technical Education)
FACS (Family and Consumer Science)
NYSAA (New York State Alternative Assessment)
CSE (Committee on Special Education)
OT/PT (Occupational & Physical Therapy)
LOTE (Language Other Than English)
ATS (Alternative To Suspension)
STEM (Science/Technology/Engineering/Math)
AIS (Academic Intervention Services)
REC (Student Records)
ST (Storage)
GS (General Science)
SS (Social Studies)
CAD (Computer Aided Design)
GR (Grade)
CR (Classroom)

- CIRCULATION
- CIRCULATION ADDITION
- CLASSROOM
- STAIR
- SUPPORT
- TOILET/STORAGE

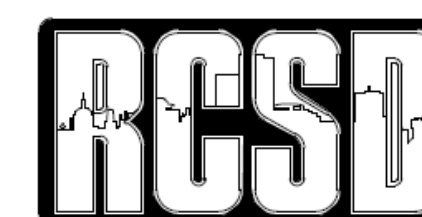
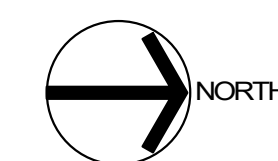

Wilson Commencement High School

501 Genesee St, Rochester, NY 14611

FIRST FLOOR

CORE MODEL PROGRAM 9-12 = 880
STUDENTS

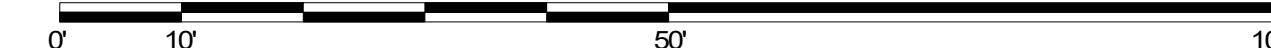

PHASE III STRATEGIC PLAN
Rochester School Modernization Program

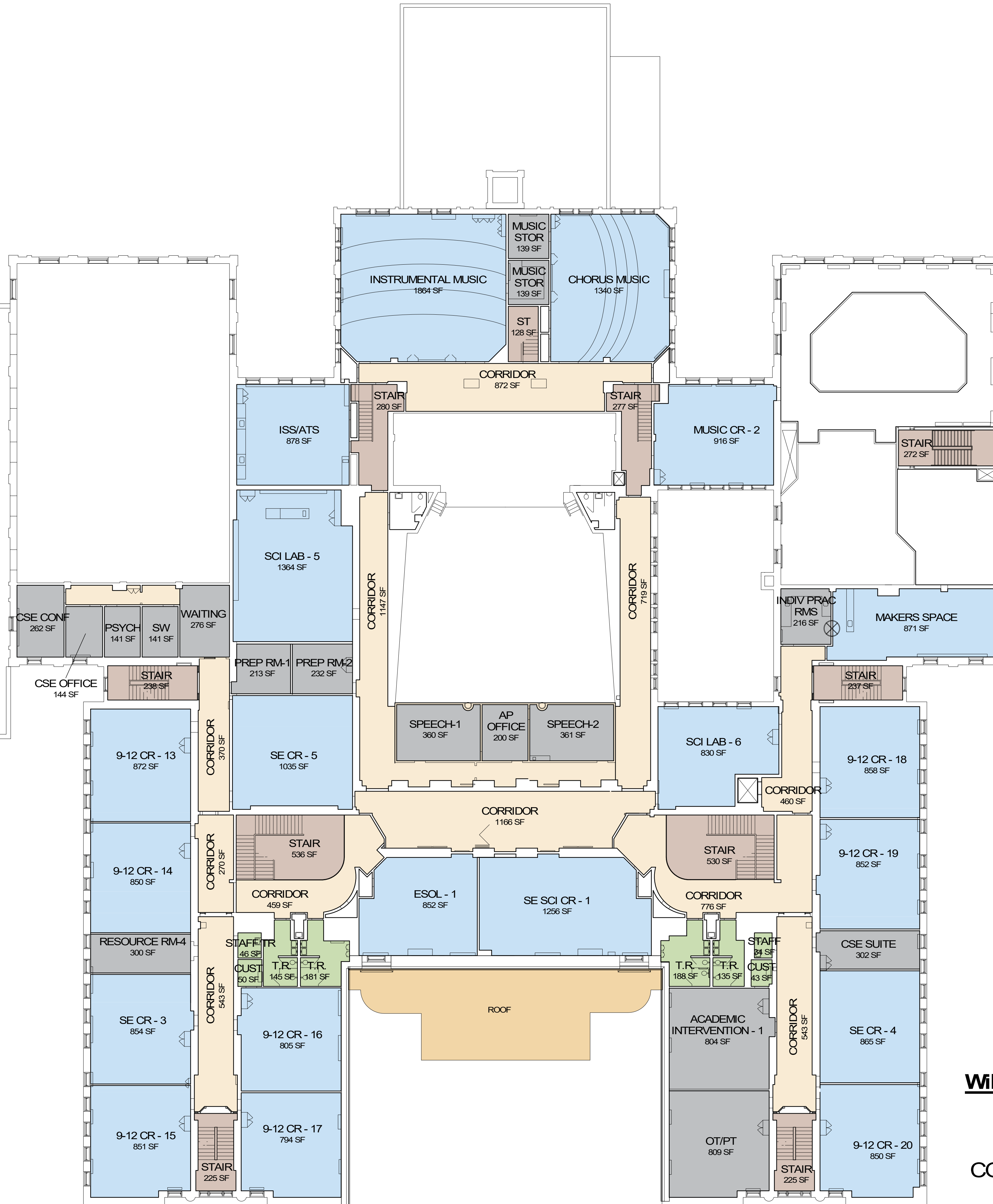

- KEY:
- ELA (English Language Art)
 - CTE (Career and Technical Education)
 - FACS (Family and Consumer Science)
 - NYSAA (New York State Alternative Assessment)
 - CSE (Committee on Special Education)
 - OT/PT (Occupational & Physical Therapy)
 - LOTE (Language Other Than English)
 - ATS (Alternative To Suspension)
 - STEM (Science/Technology/Engineering/Math)
 - AIS (Academic Intervention Services)
 - REC (Student Records)
 - ST (Storage)
 - GS (General Science)
 - SS (Social Studies)
 - CAD (Computer Aided Design)
 - GR (Grade)
 - CR (Classroom)

- CIRCULATION
- CIRCULATION ADDITION
- CLASSROOM
- STAIR
- SUPPORT
- TOILET/STORAGE

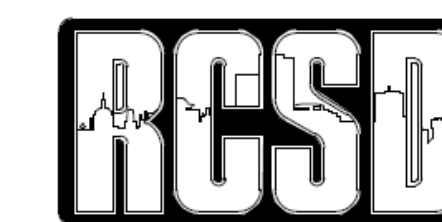
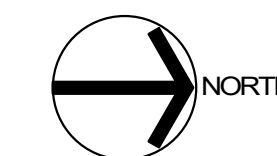

Wilson Commencement High School

501 Genesee St, Rochester, NY 14611

SECOND FLOOR

CORE MODEL PROGRAM 9-12 = 880 STUDENTS



PHASE III STRATEGIC PLAN
Rochester School Modernization Program

- KEY:
- ELA (English Language Art)
 - CTE (Career and Technical Education)
 - FACS (Family and Consumer Science)
 - NYSAA (New York State Alternative Assessment)
 - CSE (Committee on Special Education)
 - OT/PT (Occupational & Physical Therapy)
 - LOTE (Language Other Than English)
 - ATS (Alternative To Suspension)
 - STEM (Science/Technology/Engineering/Math)
 - AIS (Academic Intervention Services)
 - REC (Student Records)
 - ST (Storage)
 - GS (General Science)
 - SS (Social Studies)
 - CAD (Computer Aided Design)
 - GR (Grade)
 - CR (Classroom)

- CIRCULATION
- CIRCULATION ADDITION
- CLASSROOM
- STAIR
- SUPPORT
- TOILET/STORAGE

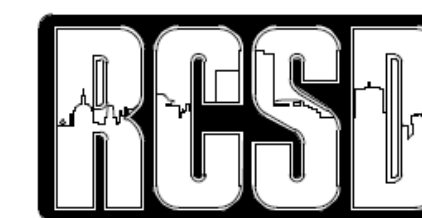
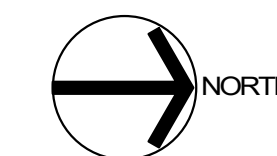

Wilson Commencement High School

501 Genesee St, Rochester, NY 14611

THIRD FLOOR

CORE MODEL PROGRAM 9-12 = 880
STUDENTS



PHASE III STRATEGIC PLAN
Rochester School Modernization Program

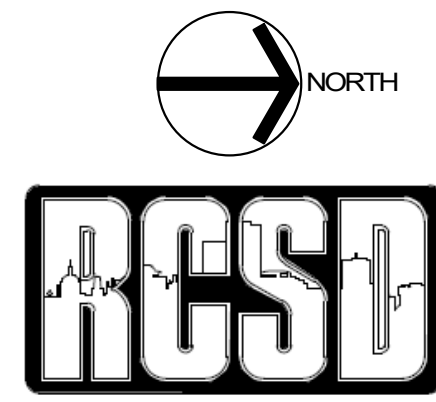
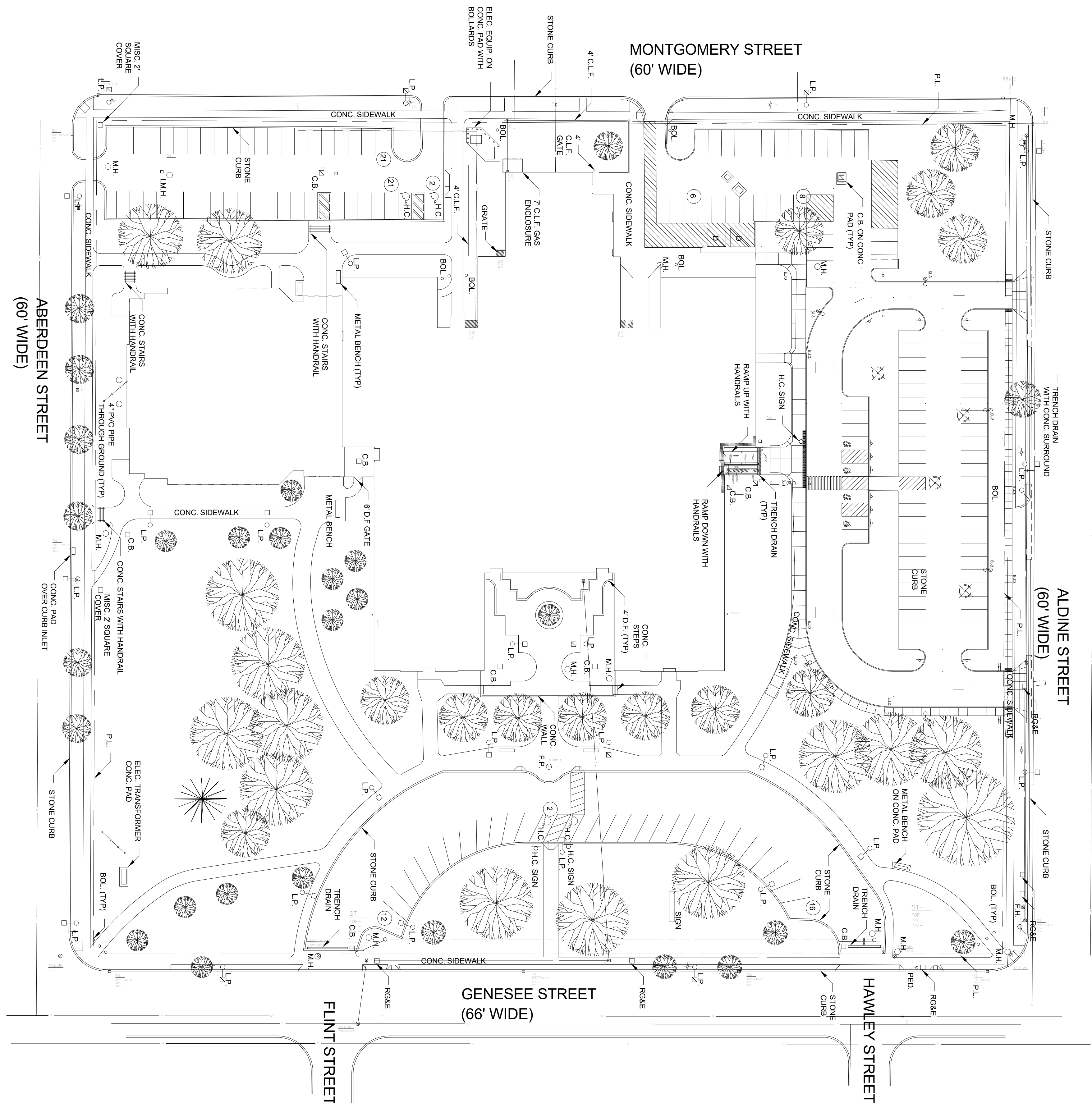

Wilson Commencement High School

501 Genesee St, Rochester, NY 14611

SITE

CORE MODEL PROGRAM 9-12 = 880 STUDENTS



Wilson Commencement HS
Pre-Conceptual Test Fit

ROCHESTER CITY SCHOOL DISTRICT